



COMPASS TRADING

“Your Compass for Quality”

**COMPASS
CATALOG**

2018



sales@compass-trading.net



www.compass-trading.net

Compass Products:

Cable Trunking System BS 4678-1:1971: Steel surface trunking BS EN 50085-1:2005: Cable trunking systems and cable ducting systems for electrical installations. General requirements BS EN 50085-2-1:2006: Cable trunking systems and cable ducting systems for electrical installations. Cable trunking systems and cable ducting systems intended for mounting on walls and ceilings

Underfloor Trunking System BS EN 50085-2-2:2008: Cable trunking systems and cable ducting systems for electrical installations. Particular requirements for cable trunking systems and cable ducting systems intended for mounting underfloor, flushfloor, or onfloor

Cable Tray, Cable Ladder and Wire-mesh Cable Tray BS EN 61537:2007: Cable management, cable tray systems and cable ladder systems NEMA VE 1-2009: Metal Cable Tray Systems

Steel Conduit BS 31:1940: Specification. Steel Conduit and fittings for electrical wirings BS 4568-1:1970: Specification for steel conduit and fittings with metric threads of ISO form for electrical installations. Steel Conduit, bends and couplers

uPVC Conduit BS EN 61386-1:2008: Conduit systems for cable management. General requirements

Strut System MFMA-4: Metal Farming Standards Publication 2004 Revision BS 6946:1988: Specification for metal channel cable support systems for electrical installations

MATERIAL: Products of COMPASS are manufactured according to the following international standard which is applicable:

1.Cold-rolled Steel Sheet to JIS G3141 SPCC-SD equivalent to BS EN 10130 Cold Rolled Steel Sheets/coils are widely used in various applications, such as industrial goods, automobile components, precision tubes and consumer durable. These are generally used to manufacture bodies of vehicles, railway coaches, earth moving equipments, material handling equipments, consumer goods like washing machines, bicycles and its parts, office equipments and furniture. Cold-Rolled steels can also be specified as dent resistant or bake hardenable for applications that require dent resistance after forming and painting. Each grade can be processed with several surface finishes depending on customer requirements. Lubricants can be applied to enhance formability and to avoid at-press lubrication.

Standard grades for cold rolled sheets used comply with **JIS G3141 SPCC-SD equivalent to BS EN 10130** - Commercial Grade moderately formed; a specimen cut in any direction can be bent flat on itself without cracking.

2.Hot-rolled Steel Sheet to JIS G3131 SPHC equivalent to BS EN 10025 Hot-rolled steel from which the iron oxides present at the surface has been removed in a pickling process. Pickled Hot Rolled Coil can be found on the market in coil or in sheets and is further processed into finished products by the manufacturer. Hot Rolled steel is heated at a very high level (over 1600 o F) and is pressed into shapes. It is generally used in parts where rust proofing is not critical. There are processes that allow hot rolled sheets to prevent rust as well. This process is called HRP & O Hot rolled pickled and oiled. Hot Rolled sheets have the most flexibility regarding how parts are welded together as well. This is the most basic form of carbon steel. Steel becomes very mouldable when heated at high temperatures, but is extremely strong and almost impossible to mould when at room temperature. It becomes completely unbendable after cooling. This is why there are many shapes to hot rolled steel products, and relatively few Cold Rolled Steel Shapes.

3.Pre-galvanized Zinc Coated Steel Sheet Hot-dip galvanizing is a form of galvanization. It is the process of coating iron or steel with a thin zinc layer, by passing the steel through a molten bath of zinc at a temperature of around 860 o F (460 o C). When exposed to the atmosphere, pure zinc reacts with oxygen to form zinc oxide, which further reacts with carbon dioxide to form zinc carbonate, a dull grey, fairly strong material that stops further corrosion in many circumstances, protecting the steel below from the elements.

Galvanized steel is widely used in applications where rust resistance is needed, and can be identified by the crystallization patterning on the surface (often called a "spangle"). Galvanized steel can be used in extreme heat. As a matter of fact, galvanized steel can be exposed to around 390 o F before the Zinc will begin peeling from the steel.

Pre-galvanized Zinc Coated Steel Sheet used by COMPASS comply with JIS G3302 equivalent to BS EN 10142 (BS EN10142 supersedes Bs2989)

4.Stainless Steel Sheet Stainless Steel is a very versatile and useful material used in a wide variety of applications. It is do used in the Architecture, building and construction field.

Stainless steel differs from carbon steel by amount of chromium present. Carbon steel rusts when exposed to air and moisture. This iron oxide film is active and accelerates corrosion by forming more iron oxide. Stainless steels have sufficient amount of chromium present so that a passive film of chromium oxide forms which prevents further surface corrosion and blocks corrosion spreading in the metal's internal structure.

High alloy steel used mainly for its anti-corrosion properties and contain a minimum of 10.5 percent of chromium which enables the steel to withstand corrosive atmosphere or erosive chemical environments. Stainless steel is more expensive than carbon and alloy steel and only accounts for a small number of steel used in the global market, but it is nonetheless a very valuable international market.

304, 316, 316L is a chromium-nickel alloy and its strength is developed by cold working. It is non-magnetic, not heat treatable and has good formability. By adding molybdenum, the corrosion resistance is increased. It is used in a food equipment, chemical equipment and architectural applications.

Stainless Steel Sheet used by COMPASS comply with SUS 304, SUS 316 (AISI Type 304 or AISI Type 316)

5.Electro-galvanized Steel Sheet EG Obtained by electro-plating the finished Cold Rolled Steel with a thin layer of zinc or zinc-nicket to provide corrosion resistance. Electro-galvanized Coil can be found on the market in coil or in sheets and is further processed into finished products by the manufacturer. Electro-galvanized coil features excellent forming properties, paintability, weldability, and is suitable for fabrication by forming, pressing and bending. Applications include domestic applications; building applications (for example, wall elements, roofing applications, automotive applications (for example, body in white for vehicles under body auto parts), lightning fixtures, drums and various kinds of sections applications, profiled sheets.

Electro-galvanized steel sheet used by COMPASS complies with JIS G3313 SECC equivalent to BS EN 10152.

CODE TABLE



CABLE TRAYS

CT cable trays **model**
CT30 cable trays **height**
CT3010 cable trays **width**
CT301010 cable trays **thickness**



page 1-7



CABLE TRUNKING

CTR cable trunking **model**
CTR40 cable trunking **height**
CTR4015 cable trunking **width**
CTR401015 cable trunking **thickness**



page 9-10



MEDIUM DUTY

CABLE LADDERS

CL cable ladder **model**
CL40 cable ladder **height**
CL4015 cable ladder **width**
CL401015 cable ladder **thickness**



page 11



HEAVY DUTY

CABLE LADDERS

CHL cable ladder **model**
CHL70 cable ladder **height**
CHL7010 cable ladder **width**
CHL701015 cable ladder **thickness**



page 12-15



WIREMESH

CABLE TRAYS

CWB cable basket **model**
CWB55 cable basket **height**
CWB5510 cable basket **width**
CWB551004 cable basket **thickness**



page 21-23

WALL PEG-A



ORDER CODE	Ø (mm)	WEIGHT (K.G./PCS)
WPA8	8	0.020
WPA10	10	0.030
WPA12	12	0.045

WALL PEG-B



ORDER CODE	Ø (mm)	WEIGHT (K.G./PCS)
WPB8	8	0.028
WPB10	10	0.055
WPB12	12	0.080

THREADED HANGING RODS



ORDER CODE	Ø (mm)	WEIGHT (K.G./PCS)
THR8	8	0.650
THR10	10	0.900
THR12	12	1,200

WASHER-A

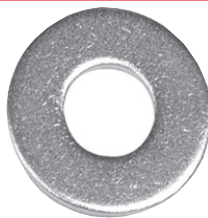

ORDER CODE	Ø (mm)	WEIGHT (K.G./PCS)
WSHA8	8	0.0012
WSHA10	10	0.0015
WSHA12	12	0.0032

DROP-IN



ORDER CODE	Ø (mm)	WEIGHT (K.G./PCS)
WPC8	8	0.022
WPC10	10	0.045
WPC12	12	0.080

SPRING NUTS

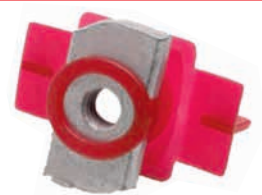

ORDER CODE	Ø (mm)	WEIGHT (K.G./PCS)
SN8	8	0.030
SN10	10	0.035
SN12	12	0.042

BOLTS



ORDER CODE	Ø (mm)	WEIGHT (K.G./PCS)
B108	8	0.015
B110	10	0.022
B112	12	0.028

EARTHING



ORDER CODE
CTE
CTR

BOLTS



ORDER CODE	Ø (mm)	WEIGHT (K.G./PCS)
B308	8	0.010
B310	10	0.025
B312	12	0.037

FLANGED NUTS



ORDER CODE	Ø (mm)	WEIGHT (K.G./PCS)
FN8	8	0.008
FN10	10	0.012
FN12	12	0.023

NUTS



ORDER CODE	Ø (mm)	WEIGHT (K.G./PCS)
N8	8	0.008
N10	10	0.010
N12	12	0.020

HANGER WASHER



ORDER CODE	Ø (mm)	WEIGHT (K.G./PCS)
SHW8	8	0.090
SHW10	10	0.195
SHW12	12	0.275

CANAL COVER



TRUNKING

ORDER CODE	H (mm)	W (mm)	T (P.G.) (mm)	WEIGHT (P.G.) (K.G./PCS)	T (H.D.G.) (mm)	WEIGHT (H.D.G.) (K.G./PCS)
CTR505010	50	50	1.0	1,863	1.0	2,050
CTR507510	50	75	1.0	2,050	1.0	2,505
CTR5010010	50	100	1.0	2,677	1.0	2,944
CTR5015010	50	150	1.0	3,123	1.0	3,816
CTR5020010	50	200	1.0	4,262	1.0	4,688
CTR757510	75	75	1.0	2,409	1.0	2,944
CTR7510010	75	100	1.0	3,070	1.0	3,377
CTR7515010	75	150	1.0	3,482	1.0	4,255
CTR7520010	75	200	1.0	4,666	1.0	5,133
CTR10010010	100	100	1.0	3,469	1.0	3,816
CTR10015010	100	150	1.0	3,836	1.0	4,688
CTR10020010	100	200	1.0	5,055	1.0	5,561
CTR15015010	150	150	1.0	4,545	1.0	5,555
CTR15020010	150	200	1.0	5,757	1.0	6,333
CTR20020010	200	200	1.0	5,977	1.0	7,305

90° BENDS

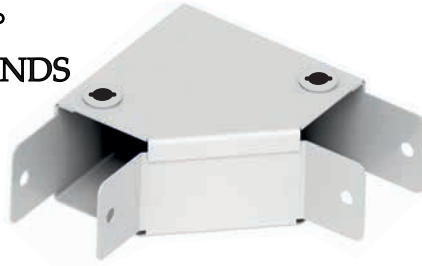

TRUNKING

ORDER CODE	H (mm)	W (mm)	T (P.G.) (mm)	WEIGHT (P.G.) (K.G./PCS)	T (H.D.G.) (mm)	WEIGHT (H.D.G.) (K.G./PCS)
CTR2505010	50	50	1.0	0,343	1.0	0,378
CTR2507510	50	75	1.0	0,418	1.0	0,511
CTR25010010	50	100	1.0	0,601	1.0	0,661
CTR25015010	50	150	1.0	0,836	1.0	1,022
CTR25020010	50	200	1.0	1,257	1.0	1,383
CTR2757510	75	75	1.0	0,500	1.0	0,611
CTR27510010	75	100	1.0	0,702	1.0	0,772
CTR27515010	75	150	1.0	0,955	1.0	1,167
CTR27520010	75	200	1.0	1,419	1.0	1,561
CTR210010010	100	100	1.0	0,808	1.0	0,889
CTR210015010	100	150	1.0	1,059	1.0	1,294
CTR210020010	100	200	1.0	1,545	1.0	1,700
CTR215015010	150	150	1.0	1,277	1.0	1,561
CTR215020010	150	200	1.0	1,778	1.0	1,955
CTR220020010	200	200	1.0	1,818	1.0	2,222

TEE BENDS

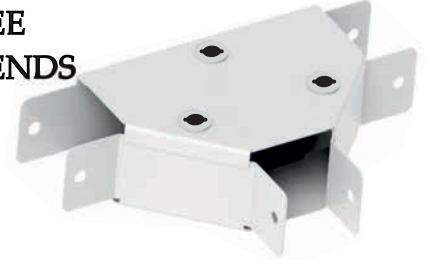

TRUNKING

ORDER CODE	H (mm)	W (mm)	T (P.G.) (mm)	WEIGHT (P.G.) (K.G./PCS)	T (H.D.G.) (mm)	WEIGHT (H.D.G.) (K.G./PCS)
CTR3505010	50	50	1.0	0,444	1.0	0,489
CTR3755010	50	75	1.0	0,514	1.0	0,628
CTR31005010	50	100	1.0	0,712	1.0	0,783
CTR31505010	50	150	1.0	0,955	1.0	1,167
CTR32005010	50	200	1.0	1,364	1.0	1,500
CTR3757510	75	75	1.0	0,614	1.0	0,750
CTR31007510	75	100	1.0	0,828	1.0	0,911
CTR31507510	75	150	1.0	1,064	1.0	1,300
CTR32007510	75	200	1.0	1,535	1.0	1,689
CTR310010010	100	100	1.0	0,939	1.0	1,033
CTR315010010	100	150	1.0	1,177	1.0	1,439
CTR320010010	100	200	1.0	1,677	1.0	1,844
CTR315015010	150	150	1.0	1,391	1.0	1,700
CTR320015010	150	200	1.0	1,899	1.0	2,089
CTR320020010	200	200	1.0	1,909	1.0	2,333

FOUR WAY BENDS

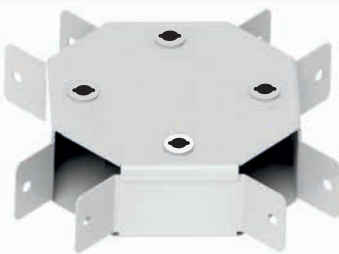

TRUNKING

ORDER CODE	H (mm)	W (mm)	T (P.G.) (mm)	WEIGHT (P.G.) (K.G./PCS)	T (H.D.G.) (mm)	WEIGHT (H.D.G.) (K.G./PCS)
CTR4505010	50	50	1.0	0,556	1.0	0,611
CTR5507510	50	75	1.0	0,000	1.0	0,755
CTR65010010	50	100	1.0	0,838	1.0	0,922
CTR75015010	50	150	1.0	0,000	1.0	1,317
CTR85020010	50	200	1.0	1,555	1.0	1,711
CTR10757510	75	75	1.0	0,000	1.0	0,883
CTR117510010	75	100	1.0	0,954	1.0	1,050
CTR127515010	75	150	1.0	0,000	1.0	1,450
CTR137520010	75	200	1.0	1,682	1.0	1,850
CTR1510010010	100	100	1.0	1,071	1.0	1,178
CTR1610015010	100	150	1.0	0,000	1.0	1,578
CTR1710020010	100	200	1.0	1,798	1.0	1,978
CTR1915015010	150	150	1.0	0,000	1.0	1,828
CTR2015020010	150	200	1.0	2,025	1.0	2,228
CTR2220020010	200	200	1.0	0,000	1.0	2,478

VERTICAL 45° BENDS



TRUNKING

ORDER CODE	H (mm)	W (mm)	T (P.G.) (mm)	WEIGHT (P.G.) (K.G./PCS)	T (H.D.G.) (mm)	WEIGHT (H.D.G.) (K.G./PCS)
CTR5505010	50	50	1.0	0,278	1.0	0,306
CTR5507510	50	75	1.0	0,286	1.0	0,350
CTR55010010	50	100	1.0	0,364	1.0	0,400
CTR55015010	50	150	1.0	0,409	1.0	0,500
CTR55020010	50	200	1.0	0,545	1.0	0,600
CTR5757510	75	75	1.0	0,341	1.0	0,417
CTR57510010	75	100	1.0	0,727	1.0	0,800
CTR57515010	75	150	1.0	0,468	1.0	0,572
CTR57520010	75	200	1.0	0,616	1.0	0,678
CTR510010010	100	100	1.0	0,530	1.0	0,583
CTR510015010	100	150	1.0	0,568	1.0	0,694
CTR510020010	100	200	1.0	0,732	1.0	0,805
CTR515015010	150	150	1.0	0,800	1.0	0,978
CTR515020010	150	200	1.0	0,960	1.0	1,055
CTR520020010	200	200	1.0	1,068	1.0	1,305

VERTICAL 90° BENDS



TRUNKING

ORDER CODE	H (mm)	W (mm)	T (P.G.) (mm)	WEIGHT (P.G.) (K.G./PCS)	T (H.D.G.) (mm)	WEIGHT (H.D.G.) (K.G./PCS)
CTR15505010	50	50	1.0	0,290	1.0	0,319
CTR15507510	50	75	1.0	0,286	1.0	0,366
CTR155010010	50	100	1.0	0,380	1.0	0,418
CTR155015010	50	150	1.0	0,409	1.0	0,523
CTR155020010	50	200	1.0	0,570	1.0	0,627
CTR15757510	75	75	1.0	0,341	1.0	0,436
CTR157510010	75	100	1.0	0,443	1.0	0,488
CTR157515010	75	150	1.0	0,468	1.0	0,598
CTR157520010	75	200	1.0	0,644	1.0	0,709
CTR1510010010	100	100	1.0	0,554	1.0	0,610
CTR1510015010	100	150	1.0	0,568	1.0	0,726
CTR1510020010	100	200	1.0	0,766	1.0	0,842
CTR1515015010	150	150	1.0	0,800	1.0	1,022
CTR1515020010	150	200	1.0	1,003	1.0	1,103
CTR1520020010	200	200	1.0	1,068	1.0	1,365

TRUNKING CONNECTION PARTS



TRUNKING

ORDER CODE	H (mm)	W (mm)	T (P.G.) (mm)	WEIGHT (P.G.) (K.G./PCS)	T (H.D.G.) (mm)	WEIGHT (H.D.G.) (K.G./PCS)
CTR15010	50	50	1.0	0,030	1.0	0,033
CTR17510	50	75	1.0	0,048	1.0	0,053
CTR110010	50	100	1.0	0,066	1.0	0,073
CTR115010	50	150	1.0	0,085	1.0	0,094
CTR120010	50	200	1.0	0,105	1.0	0,116

Trunking Cable Trays Are Producing As Electro Galvanized, Hot Dip Galvanized, SS304 Stainless Steel And SS316 Stainless Steel

Different sizes and thicknesses can be produced.

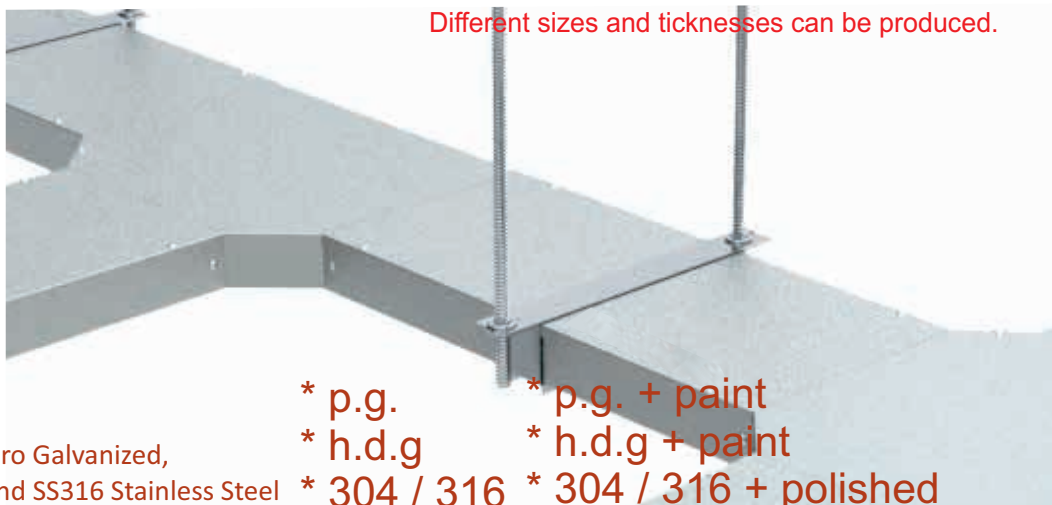

- * p.g.
- * h.d.g
- * 304 / 316
- * p.g. + paint
- * h.d.g + paint
- * 304 / 316 + polished

CANAL COVER (with separators)



TRUNKING

ORDER CODE	H (mm)	W (mm)	T (P.G.) (mm)	WEIGHT (P.G.) (K.G./PCS)	T (H.D.G.) (mm)	WEIGHT (H.D.G.) (K.G./PCS)
CTRS505010	50	50	1.0	0,495	1.0	0,544
CTRS507510	50	75	1.0	0,490	1.0	0,599
CTRS5010010	50	100	1.0	0,599	1.0	0,659
CTRS5015010	50	150	1.0	0,593	1.0	0,725
CTRS5020010	50	200	1.0	0,725	1.0	0,797
CTRS757510	75	75	1.0	0,623	1.0	0,761
CTRS7510010	75	100	1.0	0,761	1.0	0,837
CTRS7515010	75	150	1.0	0,754	1.0	0,921
CTRS7520010	75	200	1.0	0,921	1.0	1,013
CTRS10010010	100	100	1.0	0,894	1.0	0,983
CTRS10015010	100	150	1.0	0,885	1.0	1,082
CTRS10020010	100	200	1.0	1,082	1.0	1,190
CTRS15015010	150	150	1.0	1,071	1.0	1,309
CTRS15020010	150	200	1.0	1,309	1.0	1,440
CTRS20020010	200	200	1.0	1,296	1.0	1,584

VERTICAL TEE BENDS

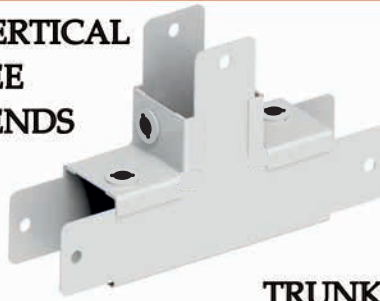

TRUNKING

ORDER CODE	H (mm)	W (mm)	T (P.G.) (mm)	WEIGHT (P.G.) (K.G./PCS)	T (H.D.G.) (mm)	WEIGHT (H.D.G.) (K.G./PCS)
CTR13505010	50	50	1.0	0,364	1.0	0,400
CTR13507510	50	75	1.0	0,391	1.0	0,478
CTR135010010	50	100	1.0	0,485	1.0	0,533
CTR135015010	50	150	1.0	0,541	1.0	0,661
CTR135020010	50	200	1.0	0,717	1.0	0,789
CTR13757510	75	75	1.0	0,523	1.0	0,639
CTR137510010	75	100	1.0	0,641	1.0	0,705
CTR137515010	75	150	1.0	0,691	1.0	0,844
CTR137520010	75	200	1.0	0,894	1.0	0,983
CTR1310010010	100	100	1.0	0,818	1.0	0,900
CTR1310015010	100	150	1.0	0,859	1.0	1,050
CTR1310020010	100	200	1.0	1,091	1.0	1,200
CTR1315015010	150	150	1.0	1,250	1.0	1,528
CTR1315020010	150	200	1.0	1,823	1.0	2,005
CTR1320020010	200	200	1.0	2,300	1.0	2,811

REDUCINGS

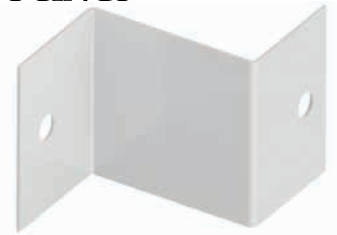

TRUNKING

ORDER CODE	H (mm)	W (mm)	T (P.G.) (mm)	WEIGHT (P.G.) (K.G./PCS)	T (H.D.G.) (mm)	WEIGHT (H.D.G.) (K.G./PCS)
CTR16502510	50	25	1.0	0,000	1.0	0,039
CTR16505010	50	50	1.0	0,000	1.0	0,050
CTR16507510	50	75	1.0	0,000	1.0	0,061
CTR165010010	50	100	1.0	0,000	1.0	0,072
CTR16752510	75	25	1.0	0,000	1.0	0,061
CTR16755010	75	50	1.0	0,000	1.0	0,078
CTR16757510	75	75	1.0	0,000	1.0	0,094
CTR167510010	75	100	1.0	0,000	1.0	0,106
CTR161002510	100	25	1.0	0,000	1.0	0,078
CTR161005010	100	50	1.0	0,000	1.0	0,100
CTR161007510	100	75	1.0	0,000	1.0	0,122
CTR1610010010	100	100	1.0	0,000	1.0	0,144
CTR161502510	150	25	1.0	0,000	1.0	0,122
CTR161505010	150	50	1.0	0,000	1.0	0,156
CTR161507510	150	75	1.0	0,000	1.0	0,183
CTR1615010010	150	100	1.0	0,000	1.0	0,217

CABLE TRAY CARRIER



TRUNKING

ORDER CODE	H (mm)	W (mm)	T (P.G.) (mm)	WEIGHT (P.G.) (K.G./PCS)	T (H.D.G.) (mm)	WEIGHT (H.D.G.) (K.G./PCS)
CTR30555510	55	55	1.0	0,0859	1.0	0,0944
CTR30858510	85	85	1.0	0,2626	1.0	0,2889
CTR3010510510	105	105	1.0	0,5303	1.0	0,5833
CTR3015515510	155	155	1.0	0,6969	1.0	0,7666
CTR3020520510	205	205	1.0	0,8636	1.0	0,9499

END CAPS



TRUNKING

ORDER CODE	H (mm)	W (mm)	T (P.G.) (mm)	WEIGHT (P.G.) (K.G./PCS)	T (H.D.G.) (mm)	WEIGHT (H.D.G.) (K.G./PCS)
CTR14505010	58	50	1.0	0,045	1.0	0,050
CTR14507510	58	75	1.0	0,050	1.0	0,061
CTR145010010	58	100	1.0	0,066	1.0	0,072
CTR145015010	58	150	1.0	0,073	1.0	0,089
CTR145020010	58	200	1.0	0,096	1.0	0,106
CTR14757510	75	75	1.0	0,073	1.0	0,089
CTR147510010	75	100	1.0	0,096	1.0	0,106
CTR147515010	75	150	1.0	0,114	1.0	0,139
CTR147520010	75	200	1.0	0,157	1.0	0,172
CTR1410010010	100	100	1.0	0,131	1.0	0,144
CTR1410015010	100	150	1.0	0,150	1.0	0,183
CTR1410020010	100	200	1.0	0,197	1.0	0,217
CTR1415015010	150	150	1.0	0,227	1.0	0,278
CTR1415020010	150	200	1.0	0,338	1.0	0,372
CTR1420020010	200	200	1.0	0,432	1.0	0,528

CABLE TRAY CARRIER

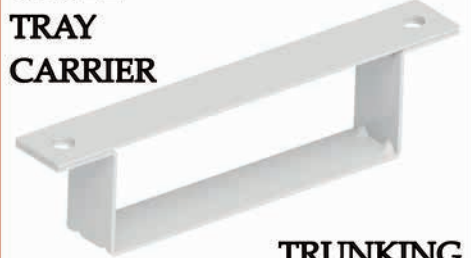

TRUNKING

ORDER CODE	H (mm)	W (mm)	T (P.G.) (mm)	WEIGHT (P.G.) (K.G./PCS)	T (H.D.G.) (mm)	WEIGHT (H.D.G.) (K.G./PCS)
CTR31505010	55	50	1.0	0,152	1.0	0,167
CTR31507510	55	75	1.0	0,159	1.0	0,194
CTR315010010	55	100	1.0	0,202	1.0	0,222
CTR315015010	55	150	1.0	0,223	1.0	0,272
CTR315020010	55	200	1.0	0,288	1.0	0,317
CTR31757510	80	75	1.0	0,182	1.0	0,222
CTR317510010	80	100	1.0	0,227	1.0	0,250
CTR317515010	80	150	1.0	0,245	1.0	0,300
CTR317520010	80	200	1.0	0,323	1.0	0,356
CTR3110010010	105	100	1.0	0,247	1.0	0,272
CTR3110015010	105	150	1.0	0,268	1.0	0,328
CTR3110020010	105	200	1.0	0,348	1.0	0,383
CTR3115015010	155	150	1.0	0,309	1.0	0,378
CTR3115020010	155	200	1.0	0,404	1.0	0,444
CTR3120020010	205	200	1.0	0,409	1.0	0,500

Different sizes and thicknesses can be produced.

BOLTS



ORDER CODE	Ø (mm)	WEIGHT (K.G./PCS)
C205	5	0.010

Trunking Cable Trays Are Producing As Electro Galvanized, Hot Dip Galvanized, SS304 Stainless Steel And SS316 Stainless Steel

2018 material thickness tolerance ± %10



- * p.g.
- * h.d.g
- * 304 / 316
- * p.g. + paint
- * h.d.g + paint
- * 304 / 316 + polished



ORDER CODE	H (mm)	W (mm)	T (H.D.G.) (mm)	WEIGHT (H.D.G.) (K.G./MT)	T (H.D.G.) (mm)	WEIGHT (H.D.G.) (K.G./MT)
CL4010015	40	100	1.5	2,195	1.5	1,930
CL4020015	40	200	1.5	2,380	1.5	2,115
CL4030015	40	300	1.5	2,560	1.5	2,295
CL4040015	40	400	1.5	2,745	1.5	2,480
CL4050015	40	500	1.5	2,935	1.5	2,670
CL4060015	40	600	1.5	2,345	1.5	2,580
CL4070020	40	700	2.0	3,975	2.0	3,625
CL4080020	40	800	2.0	4,160	2.0	3,805
CL4090020	40	900	2.0	4,350	2.0	3,995
CL40100020	40	1000	2.0	4,540	2.0	4,190



ORDER CODE	H (mm)	W (mm)	T (P.G.) (mm)	WEIGHT (P.G.) (K.G./MT)	T (H.D.G.) (mm)	WEIGHT (H.D.G.) (K.G./MT)
CL5010015	50	100	1.5	1,995	1.5	2,195
CL5020015	50	200	1.5	2,164	1.5	2,380
CL5030015	50	300	1.5	2,327	1.5	2,560
CL5040015	50	400	1.5	2,495	1.5	2,745
CL5050015	50	500	1.5	2,668	1.5	2,935
CL5060015	50	600	1.5	2,584	1.5	2,845
CL5070020	50	700	2.0	3,614	2.0	3,975
CL5080020	50	800	2.0	3,782	2.0	4,160
CL5090020	50	900	2.0	3,955	2.0	4,350
CL50100020	50	1000	2.0	4,127	2.0	4,540

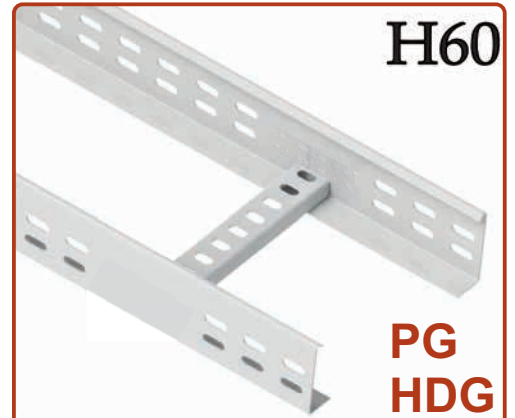

ORDER CODE	H (mm)	W (mm)	T (P.G.) (mm)	WEIGHT (P.G.) (K.G./MT)	T (H.D.G.) (mm)	WEIGHT (H.D.G.) (K.G./MT)
CL6010015	60	100	1.5	2,073	1.5	2,280
CL6020015	60	200	1.5	2,216	1.5	2,438
CL6030015	60	300	1.5	2,359	1.5	2,595
CL6040015	60	400	1.5	2,543	1.5	2,798
CL6050015	60	500	1.5	2,734	1.5	3,008
CL6060015	60	600	1.5	3,109	1.5	3,420
CL6070020	60	700	2.0	3,759	2.0	4,135
CL6080020	60	800	2.0	3,918	2.0	4,310
CL6090020	60	900	2.0	4,080	2.0	4,488
CL60100020	60	1000	2.0	4,243	2.0	4,668

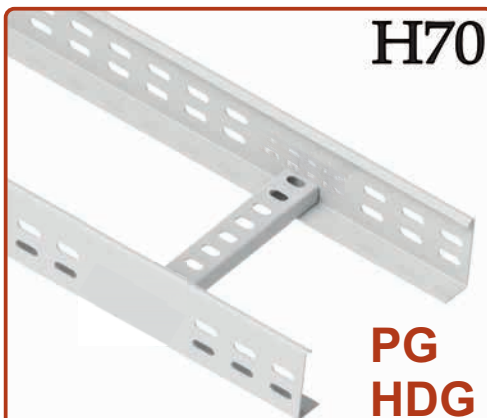

ORDER CODE	H (mm)	W (mm)	T (P.G.) (mm)	WEIGHT (P.G.) (K.G./MT)	T (H.D.G.) (mm)	WEIGHT (H.D.G.) (K.G./MT)
CL7010015	70	100	1.5	2,150	1.5	2,365
CL7020015	70	200	1.5	2,268	1.5	2,495
CL7030015	70	300	1.5	2,391	1.5	2,630
CL7040015	70	400	1.5	2,591	1.5	2,850
CL7050015	70	500	1.5	2,800	1.5	3,080
CL7060015	70	600	1.5	3,632	1.5	3,995
CL7070020	70	700	2.0	3,905	2.0	4,295
CL7080020	70	800	2.0	4,055	2.0	4,460
CL7090020	70	900	2.0	4,205	2.0	4,625
CL70100020	70	1000	2.0	4,359	2.0	4,795

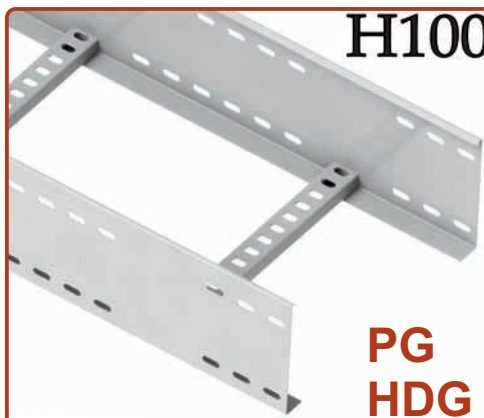

ORDER CODE	H (mm)	W (mm)	T (P.G.) (mm)	WEIGHT (P.G.) (K.G./MT)	T (H.D.G.) (mm)	WEIGHT (H.D.G.) (K.G./MT)
CL10010015	100	100	1.5	2,960	1.5	3,256
CL10020015	100	200	1.5	3,164	1.5	3,480
CL10030015	100	300	1.5	3,291	1.5	3,620
CL10040015	100	400	1.5	3,459	1.5	3,805
CL10050015	100	500	1.5	3,623	1.5	3,985
CL10060020	100	600	1.5	4,541	1.5	4,995
CL10070020	100	700	2.0	4,900	2.0	5,390
CL10080020	100	800	2.0	5,068	2.0	5,575
CL10090020	100	900	2.0	5,241	2.0	5,765
CL100100020	100	1000	2.0	5,414	2.0	5,955

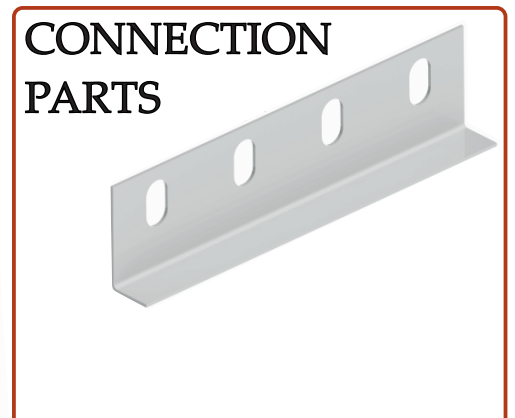

ORDER CODE	H (mm)	W (mm)	T (P.G.) (mm)	WEIGHT (P.G.) (K.G./PCS)	T (H.D.G.) (mm)	WEIGHT (H.D.G.) (K.G./PCS)
C 14012	36	140	1,20	0,072	-	-
C 14015	36	140	1,50	0,090	1,5	0,099
C 15012	46	140	1,20	0,084	-	-
C 15015	46	140	1,50	0,105	1,5	0,116
C 16012	56	140	1,20	0,096	-	-
C 16015	56	140	1,50	0,090	1,5	0,099
C 17012	66	140	1,20	0,096	-	-
C 17015	66	140	1,50	0,090	1,5	0,099
C 110012	96	140	1,20	0,192	-	-
C 110015	96	140	1,50	0,240	1,5	0,264
C 112512	121	140	1,20	0,205	-	-
C 112515	121	140	1,50	0,255	1,5	0,281
C 115012	146	140	1,20	0,265	-	-
C 115015	146	140	1,50	0,285	1,5	0,314

Code : CL5010020
CL = Cable Ladder Type
50 = Cable Ladder Height
100 = Cable Ladder Width
20 = Cable Tray Thickness

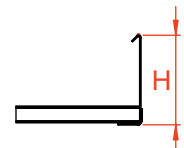
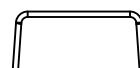
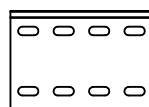



H70

HDG

ORDER CODE	H (mm)	W (mm)	T (H.D.G.) (mm)	WEIGHT (H.D.G.) (K.G./MT)
CHL7010015	70	100	1.5	2,585
CHL7020015	70	200	1.5	2,920
CHL7030015	70	300	1.5	3,255
CHL7040015	70	400	1.5	3,270
CHL7050015	70	500	1.5	3,525
CHL7060015	70	600	1.5	3,780
CHL7070020	70	700	2.0	5,370
CHL7080020	70	800	2.0	5,710
CHL7090020	70	900	2.0	6,050
CHL70100020	70	1000	2.0	6,390



H100

HDG

ORDER CODE	H (mm)	W (mm)	T (H.D.G.) (mm)	WEIGHT (H.D.G.) (K.G./MT)
CHL10010015	100	100	1.5	3,661
CHL10020015	100	200	1.5	3,990
CHL10030015	100	300	1.5	4,318
CHL10040015	100	400	1.5	4,323
CHL10050015	100	500	1.5	4,570
CHL10060015	100	600	1.5	4,815
CHL10070020	100	700	2.0	6,747
CHL10080020	100	800	2.0	7,070
CHL10090020	100	900	2.0	7,403
CHL100100020	100	1000	2.0	7,727



H125

HDG

ORDER CODE	H (mm)	W (mm)	T (H.D.G.) (mm)	WEIGHT (H.D.G.) (K.G./MT)
CHL12520015	125	200	1.5	3,855
CHL12530015	125	300	1.5	4,190
CHL12540015	125	400	1.5	5,700
CHL12550015	125	500	1.5	5,955
CHL12560015	125	600	1.5	6,250
CHL12570020	125	700	2.0	6,635
CHL12580020	125	800	2.0	6,980
CHL12590020	125	900	2.0	7,255
CHL125100020	125	1000	2.0	7,680



H150

HDG

ORDER CODE	H (mm)	W (mm)	T (HDG) (mm)	WEIGHT (HDG) (K.G./MT)
CHL15020015	150	200	1.5	4,570
CHL15030015	150	300	1.5	4,920
CHL15040015	150	400	1.5	6,550
CHL15050015	150	500	1.5	6,900
CHL15060015	150	600	2.0	7,200
CHL15070020	150	700	1.5	7,540
CHL15080020	150	800	2.0	7,865
CHL15090020	150	900	2.0	8,190
CHL150100020	150	1000	2.0	8,515



COVERS

PG HDG

ORDER CODE	H (mm)	W (mm)	T (H.D.G.) (mm)	WEIGHT (H.D.G.) (K.G./MT)	T (H.D.G.) (mm)	WEIGHT (H.D.G.) (K.G./MT)
CC101015	10	100	1.5	2,350	1.5	2,585
CC102015	10	200	1.5	2,655	1.5	2,920
CC103015	10	300	1.5	2,959	1.5	3,255
CC104015	10	400	1.5	2,973	1.5	3,270
CC105015	10	500	1.5	3,205	1.5	3,525
CC106015	10	600	1.5	4,577	1.5	5,035
CC107015	10	700	1.5	4,882	1.5	5,370
CC108015	10	800	1.5	5,191	1.5	5,710
CC109015	10	900	1.5	5,500	1.5	6,050
CC1010015	10	1000	1.5	5,809	1.5	6,390



COVER CLAMPS

ORDER CODE	H (mm)	W (mm)	T (P.G.) (mm)	WEIGHT (P.G.) (K.G./PCS)
CC40	40	20	2.0	0,020
CC50	50	20	2.0	0,028
CC60	60	20	2.0	0,035
CC70	70	20	2.0	0,042
CC100	100	20	2.0	0,075
CC125	125	20	2.0	0,105
CC150	150	20	2.0	0,135

Code : CHL7010020

CHL = Cable Ladder Type
 70 = Cable Ladder Height
 100 = Cable Ladder Width
 20 = Cable Tray Thickness

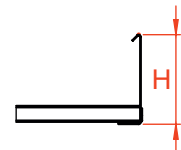
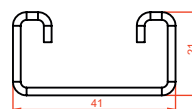
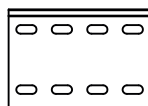

90° BENDS



ORDER CODE	H (mm)	W (mm)	T (H.D.G.) (mm)	WEIGHT (H.D.G.) (K.G./PCS)
LH2701015	70	100	1.5	1,606
LH2702015	70	200	1.5	2,046
LH2703015	70	300	1.5	3,498
LH2704020	70	400	2.0	4,4055
LH2705020	70	500	2.0	5,962
LH2706020	70	600	2.0	6,9135
LH2707020	70	700	2.0	7,843
LH2708020	70	800	2.0	8,613
LH2709020	70	900	2.0	9,537
LH27010020	70	1000	2.0	10,472
LH21001015	100	100	1.5	2,585
LH21002015	100	200	1.5	3,564
LH21003015	100	300	1.5	4,488
LH21004020	100	400	2.0	6,446
LH21005020	100	500	2.0	7,480
LH21006020	100	600	2.0	8,520
LH21007020	100	700	2.0	9,592
LH21008020	100	800	2.0	10,626
LH21009020	100	900	2.0	11,666
LH210010020	100	1000	2.0	12,700
LH21252015	125	200	1.5	2,756
LH21253015	125	300	1.5	3,498
LH21254020	125	400	2.0	5,781
LH21255020	125	500	2.0	7,475
LH21256020	125	600	2.0	8,564
LH21257020	125	700	2.0	9,631
LH21258020	125	800	2.0	10,538
LH21259020	125	900	2.0	11,600
LH212510020	125	1000	2.0	12,672
LH21502015	150	200	1.5	4,367
LH21503015	150	300	1.5	5,412
LH21504020	150	400	2.0	7,838
LH21505020	150	500	2.0	9,031
LH21506020	150	600	2.0	10,236
LH21507020	150	700	2.0	11,462
LH21508020	150	800	2.0	12,656
LH21509020	150	900	2.0	13,860
LH215010020	150	1000	2.0	15,048

TEE BENDS

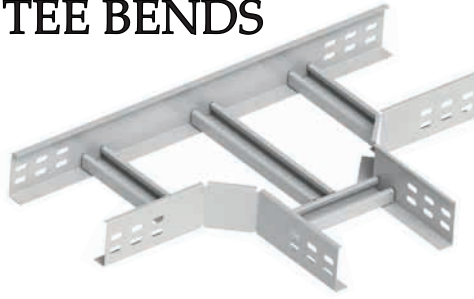

ORDER CODE	H (mm)	W (mm)	T (H.D.G.) (mm)	WEIGHT (H.D.G.) (K.G./PCS)
LH3701015	70	100	1.5	2117,5
LH3702015	70	200	1.5	2,7335
LH3703015	70	300	1.5	3,795
LH3704020	70	400	2.0	5,203
LH3705020	70	500	2.0	4,895
LH3706020	70	600	2.0	6,787
LH3707020	70	700	2.0	7,579
LH3708020	70	800	2.0	8,371
LH3709020	70	900	2.0	9,163
LH37010020	70	1000	2.0	9,955
LH31001015	100	100	1.5	4,043
LH31002015	100	200	1.5	4,879
LH31003015	100	300	1.5	5,720
LH31004020	100	400	2.0	7,728
LH31005020	100	500	2.0	8,619
LH31006020	100	600	2.0	9,510
LH31007020	100	700	2.0	10,401
LH31008020	100	800	2.0	11,292
LH31009020	100	900	2.0	12,188
LH310010020	100	1000	2.0	13,079
LH31252015	125	200	1.5	3,487
LH31253015	125	300	1.5	4,582
LH31254020	125	400	2.0	6,111
LH31255020	125	500	2.0	6,716
LH31256020	125	600	2.0	7,337
LH31257020	125	700	2.0	7,959
LH31258020	125	800	2.0	8,580
LH31259020	125	900	2.0	9,202
LH312510020	125	1000	2.0	9,823
LH31502015	150	200	1.5	5,885
LH31503015	150	300	1.5	6,782
LH31504020	150	400	2.0	9,218
LH31505020	150	500	2.0	10,192
LH31506020	150	600	2.0	11,160
LH31507020	150	700	2.0	12,128
LH31508020	150	800	2.0	13,101
LH31509020	150	900	2.0	14,179
LH315010020	150	1000	2.0	15,037

FOUR WAY BENDS



ORDER CODE	H (mm)	W (mm)	T (H.D.G.) (mm)	WEIGHT (H.D.G.) (K.G./PCS)
LH4701015	70	100	1.5	2,475
LH4702015	70	200	1.5	3,168
LH4703015	70	300	1.5	4,279
LH4704020	70	400	2.0	6,721
LH4705020	70	500	2.0	7,711
LH4706020	70	600	2.0	8,723
LH4707020	70	700	2.0	9,735
LH4708020	70	800	2.0	10,703
LH4709020	70	900	2.0	11,704
LH47010020	70	1000	2.0	12,705
LH41001015	100	100	1.5	5,220
LH41002015	100	200	1.5	6,034
LH41003015	100	300	1.5	6,848
LH41004020	100	400	2.0	8,888
LH41005020	100	500	2.0	9,697
LH41006020	100	600	2.0	10,511
LH41007020	100	700	2.0	12,645
LH41008020	100	800	2.0	13,591
LH41009020	100	900	2.0	14,542
LH410010020	100	1000	2.0	15,488
LH41252015	125	200	1.5	4,444
LH41253015	125	300	1.5	5,198
LH41254020	125	400	2.0	6,864
LH41255020	125	500	2.0	7,607
LH41256020	125	600	2.0	8,355
LH41257020	125	700	2.0	9,092
LH41258020	125	800	2.0	9,845
LH41259020	125	900	2.0	10,593
LH412510020	125	1000	2.0	11,336
LH41502015	150	200	1.5	7,079
LH41503015	150	300	1.5	7,893
LH41504020	150	400	2.0	10,280
LH41505020	150	500	2.0	11,094
LH41506020	150	600	2.0	11,902
LH41507020	150	700	2.0	14,042
LH41508020	150	800	2.0	14,988
LH41509020	150	900	2.0	15,928
LH415010020	150	1000	2.0	16,880

LEVEL CHANGE UNITS

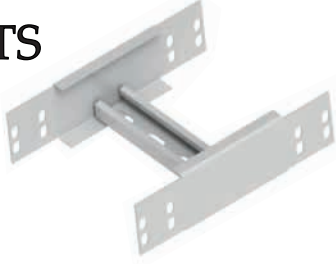

ORDER CODE	H (mm)	W (mm)	T (H.D.G.) (mm)	WEIGHT (H.D.G.) (K.G./PCS)
LH6701015	70	100	1.5	0,671
LH6702015	70	200	1.5	0,792
LH6703015	70	300	1.5	0,913
LH6704020	70	400	2.0	1,221
LH6705020	70	500	2.0	1,348
LH6706020	70	600	2.0	1,469
LH6707020	70	700	2.0	1,595
LH6708020	70	800	2.0	1,716
LH6709020	70	900	2.0	1,843
LH67010020	70	1000	2.0	1,969
LH61001015	100	100	1.5	0,913
LH61002015	100	200	1.5	1,012
LH61003015	100	300	1.5	1,117
LH61004020	100	400	2.0	1,617
LH61005020	100	500	2.0	1,755
LH61006020	100	600	2.0	1,887
LH61007020	100	700	2.0	2,019
LH61008020	100	800	2.0	2,151
LH61009020	100	900	2.0	2,283
LH610010020	100	1000	2.0	2,415
LH61252015	125	200	1.5	1,128
LH61253015	125	300	1.5	1,447
LH61254020	125	400	2.0	1,672
LH61255020	125	500	2.0	1,793
LH61256020	125	600	2.0	1,920
LH61257020	125	700	2.0	2,041
LH61258020	125	800	2.0	2,167
LH61259020	125	900	2.0	2,288
LH612510020	125	1000	2.0	2,415
LH61502015	150	200	1.5	1,436
LH61503015	150	300	1.5	1,573
LH61504020	150	400	2.0	2,096
LH61505020	150	500	2.0	1,133
LH61506020	150	600	2.0	2,365
LH61507020	150	700	2.0	2,585
LH61508020	150	800	2.0	2,778
LH61509020	150	900	2.0	3,031
LH61501020	150	1000	2.0	3,229

VERTICAL TEES



ORDER CODE	H (mm)	W (mm)	T (H.D.G.) (mm)	WEIGHT (H.D.G.) (K.G./PCS)
LH11701015	70	100	1.5	2,453
LH11702015	70	200	1.5	2,948
LH11703015	70	300	1.5	3,438
LH11704020	70	400	2.0	4,598
LH11705020	70	500	2.0	5,093
LH11706020	70	600	2.0	5,594
LH11707020	70	700	2.0	6,089
LH11708020	70	800	2.0	6,589
LH11709020	70	900	2.0	7,084
LH117010020	70	1000	2.0	7,579
LH111001015	100	100	1.5	4,686
LH111002015	100	200	1.5	6,518
LH111003015	100	300	1.5	7,497
LH111004020	100	400	2.0	11,864
LH111005020	100	500	2.0	13,739
LH111006020	100	600	2.0	15,615
LH111007020	100	700	2.0	17,490
LH111008020	100	800	2.0	19,366
LH111009020	100	900	2.0	21,241
LH1110010020	100	1000	2.0	23,117
LH111252015	125	200	1.5	7,986
LH111253015	125	300	1.5	9,735
LH111254020	125	400	2.0	14,608
LH111255020	125	500	2.0	16,764
LH111256020	125	600	2.0	18,920
LH111257020	125	700	2.0	21,175
LH111258020	125	800	2.0	23,293
LH111259020	125	900	2.0	25,465
LH1112510020	125	1000	2.0	27,610
LH111502015	150	200	1.5	7,986
LH111503015	150	300	1.5	9,735
LH111504020	150	400	2.0	14,608
LH111505020	150	500	2.0	16,764
LH111506020	150	600	2.0	18,920
LH111507020	150	700	2.0	21,175
LH111508020	150	800	2.0	23,337
LH111509020	150	900	2.0	25,520
LH1115010020	150	1000	2.0	27,665

MIDDLE TEES

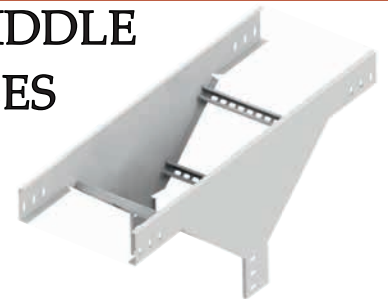

ORDER CODE	H (mm)	W (mm)	T (H.D.G.) (mm)	WEIGHT (H.D.G.) (K.G./PCS)
LH12701015	70	100	1.5	3,812
LH12702015	70	200	1.5	4,307
LH12703015	70	300	1.5	4,802
LH12704020	70	400	2.0	6,413
LH12705020	70	500	2.0	6,908
LH12706020	70	600	2.0	7,409
LH12707020	70	700	2.0	7,904
LH12708020	70	800	2.0	8,421
LH12709020	70	900	2.0	8,899
LH127010020	70	1000	2.0	9,394
LH121001015	100	100	1.5	5,649
LH121002015	100	200	1.5	6,056
LH121003015	100	300	1.5	6,457
LH121004020	100	400	2.0	9,147
LH121005020	100	500	2.0	9,686
LH121006020	100	600	2.0	10,225
LH121007020	100	700	2.0	10,764
LH121008020	100	800	2.0	11,341
LH121009020	100	900	2.0	11,919
LH1210010020	100	1000	2.0	12,496
LH121252015	125	200	1.5	8,217
LH121253015	125	300	1.5	8,756
LH121254020	125	400	2.0	11,682
LH121255020	125	500	2.0	12,221
LH121256020	125	600	2.0	12,755
LH121257020	125	700	2.0	13,255
LH121258020	125	800	2.0	13,778
LH121259020	125	900	2.0	14,416
LH1212510020	125	1000	2.0	14,988
LH121502015	150	200	1.5	8,217
LH121503015	150	300	1.5	8,756
LH121504020	150	400	2.0	11,682
LH121505020	150	500	2.0	12,221
LH121506020	150	600	2.0	12,755
LH121507020	150	700	2.0	13,310
LH121508020	150	800	2.0	13,888
LH121509020	150	900	2.0	14,416
LH1215010020	150	1000	2.0	15,648

INSIDE OUTSIDE 90° BENDS

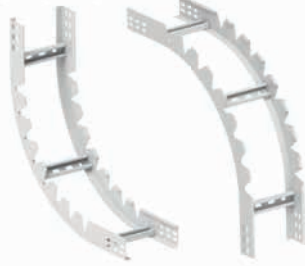

INSIDE VERTICAL BENDS (FIXED)



OUTSIDE VERTICAL BENDS (FIXED)



ORDER CODE	H (mm)	W (mm)	T (H.D.G.) (mm)	WEIGHT (H.D.G.) (K.G./PCS)
LH15701015	70	100	1.5	3,223
LH15702015	70	200	1.5	3,322
LH15703015	70	300	1.5	3,421
LH15704020	70	400	2.0	4,697
LH15705020	70	500	2.0	4,835
LH15706020	70	600	2.0	4,967
LH15707020	70	700	2.0	5,099
LH15708020	70	800	2.0	5,231
LH15709020	70	900	2.0	5,363
LH157010020	70	1000	2.0	5,500
LH151001015	100	100	1.5	2,959
LH151002015	100	200	1.5	3,333
LH151003015	100	300	1.5	3,702
LH151004020	100	400	2.0	4,945
LH151005020	100	500	2.0	5,319
LH151006020	100	600	2.0	5,693
LH151007020	100	700	2.0	6,067
LH151008020	100	800	2.0	6,441
LH151009020	100	900	2.0	6,809
LH1510010020	100	1000	2.0	6,985
LH151252015	125	200	1.5	4,307
LH151253015	125	300	1.5	4,444
LH151254020	125	400	2.0	5,924
LH151255020	125	500	2.0	6,061
LH151256020	125	600	2.0	6,193
LH151257020	125	700	2.0	7,513
LH151258020	125	800	2.0	8,833
LH151259020	125	900	2.0	10,153
LH1512510020	125	1000	2.0	11,473
LH151502015	150	200	1.5	4,307
LH151503015	150	300	1.5	4,444
LH151504020	150	400	2.0	5,924
LH151505020	150	500	2.0	6,061
LH151506020	150	600	2.0	6,193
LH151507020	150	700	2.0	7,513
LH151508020	150	800	2.0	8,833
LH151509020	150	900	2.0	10,153
LH1515010020	150	1000	2.0	11,473

ORDER CODE	H (mm)	W (mm)	T (H.D.G.) (mm)	WEIGHT (H.D.G.) (K.G./PCS)
LH17701015	70	100	1.5	1,551
LH17702015	70	200	1.5	1,678
LH17703015	70	300	1.5	1,799
LH17704020	70	400	2.0	2,415
LH17705020	70	500	2.0	2,541
LH17706020	70	600	2.0	2,662
LH17707020	70	700	2.0	2,789
LH17708020	70	800	2.0	2,915
LH17709020	70	900	2.0	3,036
LH177010020	70	1000	2.0	3,163
LH171001015	100	100	1.5	1,843
LH171002015	100	200	1.5	1,942
LH171003015	100	300	1.5	2,046
LH171004020	100	400	2.0	2,860
LH171005020	100	500	2.0	2,992
LH171006020	100	600	2.0	3,130
LH171007020	100	700	2.0	3,267
LH171008020	100	800	2.0	3,405
LH171009020	100	900	2.0	3,542
LH1710010020	100	1000	2.0	3,680
LH171252015	125	200	1.5	2,027
LH171253015	125	300	1.5	2,136
LH171254020	125	400	2.0	2,251
LH171255020	125	500	2.0	3,146
LH171256020	125	600	2.0	3,291
LH171257020	125	700	2.0	3,442
LH171258020	125	800	2.0	3,594
LH171259020	125	900	2.0	3,745
LH1712510020	125	1000	2.0	3,896
LH171502015	150	200	1.5	2,442
LH171503015	150	300	1.5	2,574
LH171504020	150	400	2.0	3,438
LH171505020	150	500	2.0	3,570
LH171506020	150	600	2.0	3,702
LH171507020	150	700	2.0	3,834
LH171508020	150	800	2.0	3,966
LH171509020	150	900	2.0	4,098
LH1715010020	150	1000	2.0	4,230

ORDER CODE	H (mm)	W (mm)	T (H.D.G.) (mm)	WEIGHT (H.D.G.) (K.G./PCS)
LH18701015	70	100	1.5	1,551
LH18702015	70	200	1.5	1,678
LH18703015	70	300	1.5	1,799
LH18704020	70	400	2.0	2,415
LH18705020	70	500	2.0	2,541
LH18706020	70	600	2.0	2,662
LH18707020	70	700	2.0	2,789
LH18708020	70	800	2.0	2,910
LH18709020	70	900	2.0	3,036
LH187010020	70	1000	2.0	3,163
LH181001015	100	100	1.5	1,843
LH181002015	100	200	1.5	1,942
LH181003015	100	300	1.5	2,046
LH181004020	100	400	2.0	2,860
LH181005020	100	500	2.0	2,992
LH181006020	100	600	2.0	3,130
LH181007020	100	700	2.0	3,267
LH181008020	100	800	2.0	3,405
LH181009020	100	900	2.0	3,542
LH1810010020	100	1000	2.0	3,680
LH181252015	125	200	1.5	2,027
LH181253015	125	300	1.5	2,136
LH181254020	125	400	2.0	2,251
LH181255020	125	500	2.0	3,146
LH181256020	125	600	2.0	3,291
LH181257020	125	700	2.0	3,442
LH181258020	125	800	2.0	3,594
LH181259020	125	900	2.0	3,745
LH1812510020	125	1000	2.0	3,896
LH181502015	150	200	1.5	2,442
LH181503015	150	300	1.5	2,574
LH181504020	150	400	2.0	3,438
LH181505020	150	500	2.0	3,570
LH181506020	150	600	2.0	3,702
LH181507020	150	700	2.0	3,834
LH181508020	150	800	2.0	3,966
LH181509020	150	900	2.0	4,098
LH1815010020	150	1000	2.0	4,230



41X21 C PROFILES

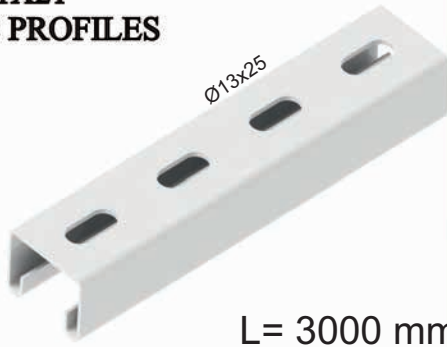

L = 3000 mm

ORDER CODE	H (mm)	W (mm)	L (mm)	T (P.G.) (mm)	WEIGHT (P.G.) (K.G./PCS)	T (H.D.G.) (mm)	WEIGHT (H.D.G.) (K.G./PCS)
C3002115	21	41	3000	1.5	1,111	1.5	1,222
C3002120	21	41	3000	2.0	1,480	2.0	1,628
C3002125	21	41	3000	2.5	1,853	2.5	2,039

41X21 C BRACKETS

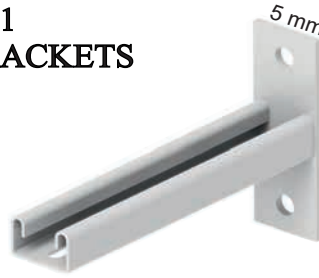

ORDER CODE	H (mm)	W (mm)	L (mm)	T (H.D.G.) (mm)	WEIGHT (H.D.G.) (K.G./PCS)
CB211015	21	41	100	1.5	0.468
CB212015	21	41	200	1.5	0.600
CB213015	21	41	300	1.5	0.737
CB214020	21	41	400	2.0	1.051
CB215020	21	41	500	2.0	1.227
CB216020	21	41	600	2.0	1.403

41X21 C BRACKETS (DOUBLE)

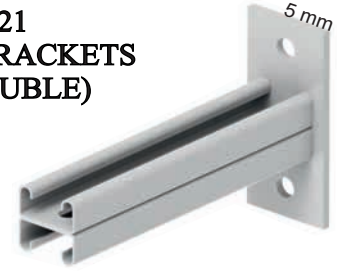

ORDER CODE	H (mm)	W (mm)	L (mm)	T (H.D.G.) (mm)	WEIGHT (H.D.G.) (K.G./PCS)
CB21D1015	21	41	100	1.5	0.566
CB21D2015	21	41	200	1.5	0.808
CB21D3015	21	41	300	1.5	1.055
CB21D4020	21	41	400	2.0	1.631
CB21D5020	21	41	500	2.0	1.954
CB21D6020	21	41	600	2.0	2.283

41X41 C PROFILES

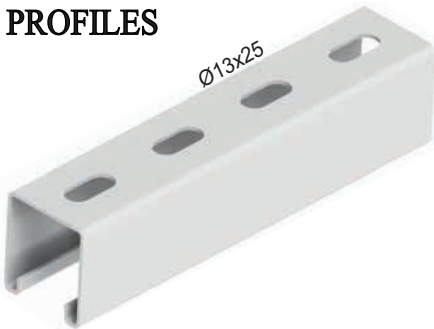

L = 3000 mm

ORDER CODE	H (mm)	W (mm)	L (mm)	T (P.G.) (mm)	WEIGHT (P.G.) (K.G./PCS)	T (H.D.G.) (mm)	WEIGHT (H.D.G.) (K.G./PCS)
C3004115	41	41	3000	1.5	1,434	1.5	1,578
C3004120	41	41	3000	2.0	1,914	2.0	2,105
C3004125	41	41	3000	2.5	2,394	2.5	2,633

41X41 C BRACKETS

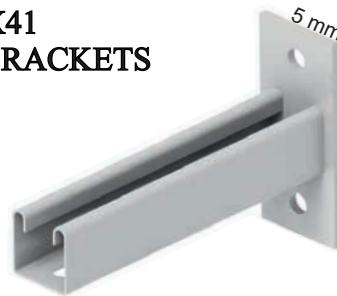

ORDER CODE	H (mm)	W (mm)	L (mm)	T (H.D.G.) (mm)	WEIGHT (H.D.G.) (K.G./PCS)
CB411015	41	41	100	1.5	0.490
CB412015	41	41	200	1.5	0.662
CB413015	41	41	300	1.5	0.838
CB414020	41	41	400	2.0	1.252
CB415020	41	41	500	2.0	1.485
CB416020	41	41	600	2.0	1.717

41X41 C BRACKETS (DOUBLE)

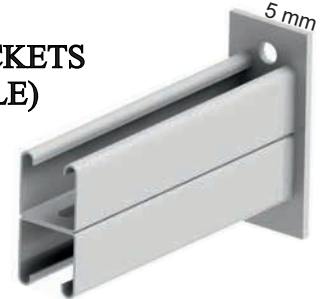

ORDER CODE	H (mm)	W (mm)	L (mm)	T (H.D.G.) (mm)	WEIGHT (H.D.G.) (K.G./PCS)
CB41D1015	41	41	100	1.5	1.227
CB41D2015	41	41	200	1.5	1.470
CB41D3015	41	41	300	1.5	1.712
CB41D4020	41	41	400	2.0	1.631
CB41D5020	41	41	500	2.0	1.954
CB41D6020	41	41	600	2.0	2.283

41X21 41x41 C HANGING SUPPORT



ORDER CODE	H (mm)	W (mm)	T (H.D.G.) (mm)	WEIGHT (H.D.G.) (K.G./PCS)
CH412120	41	21	2.0	0.450
CH414120	41	41	2.0	0.515

41X21 C HANGING SUPPORT CEILING

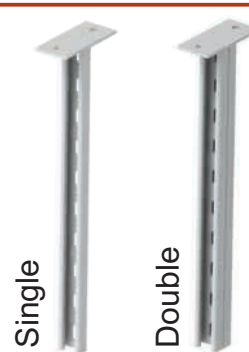

ORDER CODE	H (mm)	W (mm)	L (mm)	T (H.D.G.) (mm)	WEIGHT (H.D.G.) (K.G./PCS)
CH2215020	21	41	500	2.0	1,111
CH22110020	21	41	1000	2.0	1,924
CH22115020	21	41	1500	2.0	2,737
CH22120020	21	41	2000	2.0	3,550
CH22125020	21	41	2500	2.0	4,363
CH22130020	21	41	3000	2.0	5,181
CH2D215020	21	41	500	2.0	1,924
CH2D2110020	21	41	1000	2.0	3,550
CH2D2115020	21	41	1500	2.0	5,176
CH2D2120020	21	41	2000	2.0	6,802
CH2D2125020	21	41	2500	2.0	8,428
CH2D2130020	21	41	3000	2.0	10,055

41X41 C HANGING SUPPORT CEILING

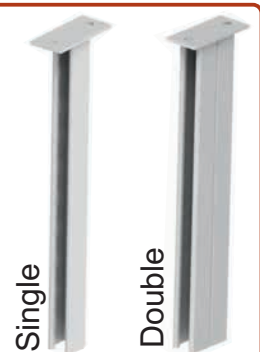

ORDER CODE	H (mm)	W (mm)	L (mm)	T (H.D.G.) (mm)	WEIGHT (H.D.G.) (K.G./PCS)
CH3415020	41	41	500	2.0	1,459
CH34110020	41	41	1000	2.0	2,621
CH34115020	41	41	1500	2.0	3,788
CH34120020	41	41	2000	2.0	4,949
CH34125020	41	41	2500	2.0	6,111
CH34130020	41	41	3000	2.0	7,272
CH3D415020	41	41	500	2.0	2,621
CH3D4110020	41	41	1000	2.0	4,949
CH3D4115020	41	41	1500	2.0	7,272
CH3D4120020	41	41	2000	2.0	9,600
CH3D4125020	41	41	2500	2.0	11,928
CH3D4130020	41	41	3000	2.0	14,251

CABLE TRAY CARRIER

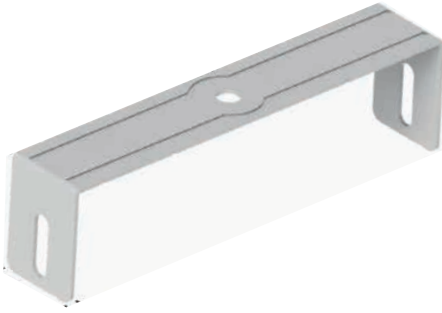

ORDER CODE	H (mm)	W (mm)	T (P.G.) (mm)	WEIGHT (P.G.) (K.G./PCS)	T (H.D.G.) (mm)	WEIGHT (H.D.G.) (K.G./PCS)
T3005512	50	50	1,2	0,065	1,2	0,072
T3010512	50	105	1,2	0,080	1,2	0,088
T3015512	50	150	1,2	0,090	1,2	0,099
T3020512	50	200	1,2	0,110	1,2	0,121

41X21 C SUPPORT

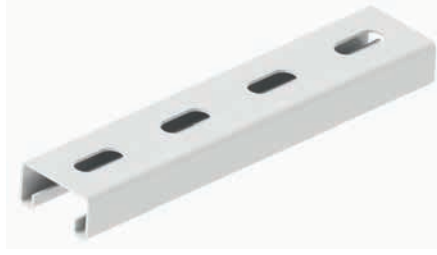

ORDER CODE	H (mm)	W (mm)	T (P.G.) (mm)	WEIGHT (P.G.) (K.G./MT)	T (H.D.G.) (mm)	WEIGHT (H.D.G.) (K.G./MT)
C202115	21	250	1,5	0,288	1,5	0,316
C302115	21	350	1,5	0,403	1,5	0,443
C402115	21	450	1,5	0,518	1,5	0,569
C502115	21	550	1,5	0,633	1,5	0,696
C602115	21	650	1,5	0,748	1,5	0,822
C702115	21	750	1,5	0,863	1,5	0,949
C802115	21	850	1,5	0,978	1,5	1,075
C902115	21	950	1,5	1,093	1,5	1,202
C1002115	21	1050	1,5	1,208	1,5	1,328
C1102115	21	1150	1,5	1,323	1,5	1,455
C1502115	21	1550	1,5	1,783	1,5	1,961
C2002115	21	2050	1,5	2,358	1,5	2,593

41X41 C SUPPORT

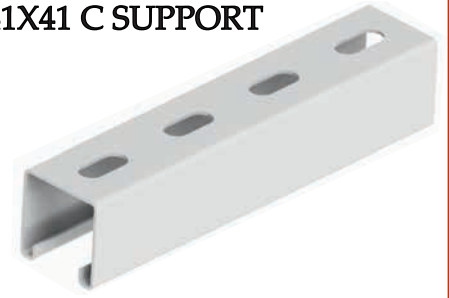

ORDER CODE	H (mm)	W (mm)	T (P.G.) (mm)	WEIGHT (P.G.) (K.G./MT)	T (H.D.G.) (mm)	WEIGHT (H.D.G.) (K.G./MT)
C204115	41	250	1,5	0,400	1,5	0,440
C304115	41	350	1,5	0,560	1,5	0,616
C404115	41	450	1,5	0,720	1,5	0,792
C504115	41	550	1,5	0,880	1,5	0,968
C604115	41	650	1,5	1,040	1,5	1,144
C704115	41	750	1,5	1,200	1,5	1,320
C804115	41	850	1,5	1,360	1,5	1,496
C904115	41	950	1,5	1,520	1,5	1,672
C1004115	41	1050	1,5	1,680	1,5	1,848
C1104115	41	1150	1,5	1,840	1,5	2,024
C1504115	41	1550	1,5	2,480	1,5	2,728
C2004115	41	2050	1,5	3,280	1,5	3,608

RUBBER STRIP

ORDER CODE
RS1



HOT DIP GALVANISED SPREY

ORDER CODE
ZS1



C PROFILE CONNECTION PARTS



ORDER CODE	T (H.D.G.) (mm)	WEIGHT (H.D.G.) (K.G./PCS)
C1	5.0	0,190

C PROFILE CONNECTION PARTS



ORDER CODE	T (H.D.G.) (mm)	WEIGHT (H.D.G.) (K.G./PCS)
C2	5.0	0,274

C PROFILE CONNECTION PARTS

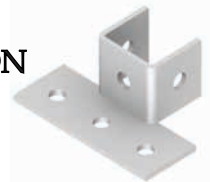

ORDER CODE	T (H.D.G.) (mm)	WEIGHT (H.D.G.) (K.G./PCS)
C3	5.0	0,460

C PROFILE CONNECTION PARTS



ORDER CODE	T (H.D.G.) (mm)	WEIGHT (H.D.G.) (K.G./PCS)
C4	5.0	0,250

C PROFILE CONNECTION PARTS



ORDER CODE	T (H.D.G.) (mm)	WEIGHT (H.D.G.) (K.G./PCS)
C5	5.0	0,450

C PROFILE CONNECTION PARTS



ORDER CODE	T (H.D.G.) (mm)	WEIGHT (H.D.G.) (K.G./PCS)
C6	5.0	0,250

C PROFILE CONNECTION PARTS



ORDER CODE	T (H.D.G.) (mm)	WEIGHT (H.D.G.) (K.G./PCS)
C7	5.0	0,485

C PROFILE CONNECTION PARTS

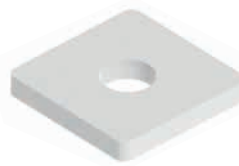

ORDER CODE	T (H.D.G.) (mm)	WEIGHT (H.D.G.) (K.G./PCS)
C8	5.0	0,062

C PROFILE CONNECTION PARTS



ORDER CODE	T (H.D.G.) (mm)	WEIGHT (H.D.G.) (K.G./PCS)
C9	5.0	0,120

C PROFILE CONNECTION PARTS



ORDER CODE	T (H.D.G.) (mm)	WEIGHT (H.D.G.) (K.G./PCS)
C10	5.0	0,300

C PROFILE CONNECTION PARTS



ORDER CODE	T (H.D.G.) (mm)	WEIGHT (H.D.G.) (K.G./PCS)
C11	5.0	0,172

C PROFILE CONNECTION PARTS



ORDER CODE	T (H.D.G.) (mm)	WEIGHT (H.D.G.) (K.G./PCS)
C12	5.0	0,300

C PROFILE CONNECTION PARTS



ORDER CODE	T (H.D.G.) (mm)	WEIGHT (H.D.G.) (K.G./PCS)
C13	5.0	0,250

C PROFILE CONNECTION PARTS



ORDER CODE	T (H.D.G.) (mm)	WEIGHT (H.D.G.) (K.G./PCS)
C14	5.0	0,250

C PROFILE CONNECTION PARTS



ORDER CODE	T (H.D.G.) (mm)	WEIGHT (H.D.G.) (K.G./PCS)
C15	5.0	0,400

C PROFILE CONNECTION PARTS



ORDER CODE	T (H.D.G.) (mm)	WEIGHT (H.D.G.) (K.G./PCS)
C16	5.0	0,450

C PROFILE CONNECTION PARTS



ORDER CODE	T (H.D.G.) (mm)	WEIGHT (H.D.G.) (K.G./PCS)
C17	5.0	0,250

C PROFILE CONNECTION PARTS



ORDER CODE	T (H.D.G.) (mm)	WEIGHT (H.D.G.) (K.G./PCS)
C18	5.0	0,178



H35 WIREMESH

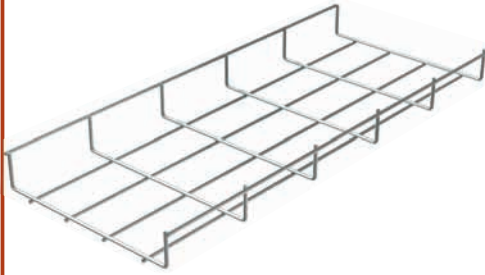

H55 WIREMESH

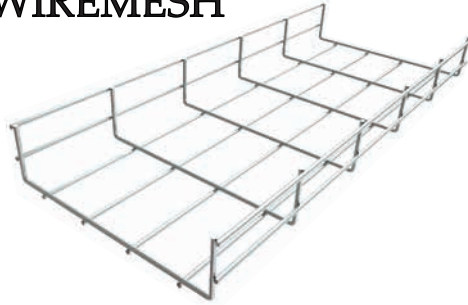

H75 WIREMESH

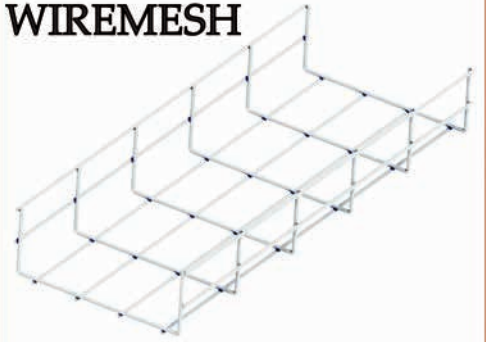

ORDER CODE	H (mm)	W (mm)	T (H.D.G.) (E.G.) (mm)	WEIGHT (E.G.) (K.G./MT)	WEIGHT (H.D.G.) (K.G./MT)
CWB35504	35	50	4	0,768	0,768
CWB35505	35	50	5	1,151	1,151
CWB351004	35	100	4	1,091	1,091
CWB351005	35	100	5	1,707	1,707
CWB351504	35	150	4	1,343	1,343
CWB351505	35	150	5	2,101	2,101
CWB352004	35	200	4	1,596	1,596
CWB352005	35	200	5	2,495	2,495
CWB352504	35	250	4	1,848	1,848
CWB352505	35	250	5	2,889	2,889
CWB353004	35	300	4	2,111	2,111
CWB353005	35	300	5	3,293	3,293
CWB353504	35	350	4	2,363	2,363
CWB353505	35	350	5	3,687	3,687
CWB354004	35	400	4	2,616	2,616
CWB354005	35	400	5	4,080	4,080
CWB354504	35	450	4	2,868	2,868
CWB354505	35	450	5	4,484	4,484
CWB355004	35	500	4	3,121	3,121
CWB355005	35	500	5	4,878	4,878
CWB355504	35	550	4	3,373	3,373
CWB355505	35	550	5	5,272	5,272
CWB356004	35	600	4	3,636	3,636
CWB356005	35	600	5	5,676	5,676

ORDER CODE	H (mm)	W (mm)	T (H.D.G.) (E.G.) (mm)	WEIGHT (E.G.) (K.G./MT)	WEIGHT (H.D.G.) (K.G./MT)
CWB55504	55	50	4	0,864	0,950
CWB55505	55	50	5	1,293	1,42
CWB551004	55	100	4	1,182	1,300
CWB551005	55	100	5	1,848	2,03
CWB551504	55	150	4	1,434	1,578
CWB551505	55	150	5	2,242	2,47
CWB552004	55	200	4	1,697	1,866
CWB552005	55	200	5	2,636	2,90
CWB552504	55	250	4	1,949	2,144
CWB552505	55	250	5	3,040	3,34
CWB553004	55	300	4	2,202	2,422
CWB553005	55	300	5	3,434	3,78
CWB553504	55	350	4	2,454	2,700
CWB553505	55	350	5	3,828	4,21
CWB554004	55	400	4	2,707	2,977
CWB554005	55	400	5	4,232	4,66
CWB554504	55	450	4	2,959	3,255
CWB554505	55	450	5	4,626	5,09
CWB555004	55	500	4	3,212	3,533
CWB555005	55	500	5	5,020	5,52
CWB555504	55	550	4	3,474	3,822
CWB555505	55	550	5	5,424	5,97
CWB556004	55	600	4	3,727	4,100
CWB556005	55	600	5	5,818	6,40

ORDER CODE	H (mm)	W (mm)	T (H.D.G.) (E.G.) (mm)	WEIGHT (E.G.) (K.G./MT)	WEIGHT (H.D.G.) (K.G./MT)
CWB751004	75	100	4	1,263	1,389
CWB751005	75	100	5	1,970	2,166
CWB751504	75	150	4	1,515	1,667
CWB751505	75	150	5	2,363	2,600
CWB752004	75	200	4	1,768	1,944
CWB752005	75	200	5	2,757	3,033
CWB752504	75	250	4	2,020	2,222
CWB752505	75	250	5	3,161	3,477
CWB753004	75	300	4	2,273	2,500
CWB753005	75	300	5	3,555	3,911
CWB753504	75	350	4	2,535	2,789
CWB753505	75	350	5	3,949	4,344
CWB754004	75	400	4	2,788	3,066
CWB754005	75	400	5	4,353	4,788
CWB754504	75	450	4	3,040	3,344
CWB754505	75	450	5	4,747	5,222
CWB755004	75	500	4	3,293	3,622
CWB755005	75	500	5	5,141	5,655
CWB755504	75	550	4	3,545	3,900
CWB755505	75	550	5	5,545	6,099
CWB756004	75	600	4	3,798	4,177
CWB756005	75	600	5	5,939	6,533

Code : CWB3510005

CWB = Cable Tray Type
35 = Wiremesh Height
100 = Wiremesh Width
05 = Wiremesh Thickness

* e.g

* h.d.g.

* 304/316

* e.g+paint

* h.d.g.+paint

* 304 / 316+polished

H105 WIREMESH

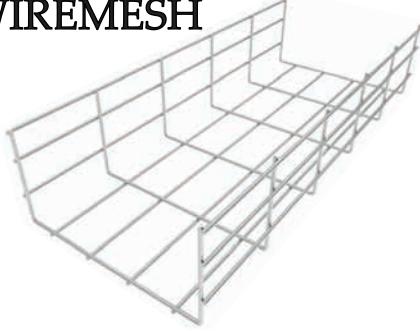

ORDER CODE	H (mm)	W (mm)	T (H.D.G.) (E.G.) (mm)	WEIGHT (E.G.) (K.G./M)	WEIGHT (H.D.G.) (K.G./M)
CWB1051004	105	100	4	1.535	1,689
CWB1051005	105	100	5	2.404	2,644
CWB1051504	105	150	4	1.788	1,966
CWB1051505	105	150	5	2.798	3,077
CWB1052004	105	200	4	2.050	2,255
CWB1052005	105	200	5	3.192	3,511
CWB1052504	105	250	4	2.303	2,533
CWB1052505	105	250	5	3.586	3,944
CWB1053004	105	300	4	2.555	2,811
CWB1053005	105	300	5	3.990	4,388
CWB1053504	105	350	4	2.808	3,089
CWB1053505	105	350	5	4.383	4,822
CWB1054004	105	400	4	3.060	3,366
CWB1054005	105	400	5	4.777	5,255
CWB1054504	105	450	4	3.313	3,644
CWB1054505	105	450	5	5.181	5,699
CWB1055004	105	500	4	3.565	3,922
CWB1055005	105	500	5	5.575	6,133
CWB1055504	105	550	4	3.828	4,211
CWB1055505	105	550	5	5.969	6,566
CWB1056004	105	600	4	4.080	4,488
CWB1056005	105	600	5	6.373	7,010

WIREMESH COVER

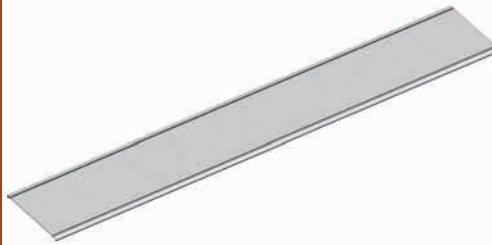

ORDER CODE	H (mm)	W (mm)	T (P.G.) (mm)	WEIGHT (P.G.) (K.G./PCS)	T (H.D.G.) (mm)	WEIGHT (H.D.G.) (K.G./PCS)
CC100506	10	50	0.6	0.330	0.7	0.363
CC101007	10	100	0.7	0.659	0.8	0.725
CC101507	10	150	0.7	0.934	0.8	1.028
CC102007	10	200	0.7	1.209	0.8	1.330
CC102507	10	250	0.7	1.484	0.8	1.632
CC103008	10	300	0.8	2.010	0.9	2.211
CC103508	10	350	0.8	2.324	0.9	2.556
CC104009	10	400	0.9	2.967	1.0	3.264
CC104509	10	450	0.9	3.321	1.0	3.653
CC105010	10	500	1.0	4.082	1.1	4.490
CC105510	10	550	1.0	4.475	1.1	4.922
CC106010	10	600	1.0	4.867	1.1	5.354

CKPE-1

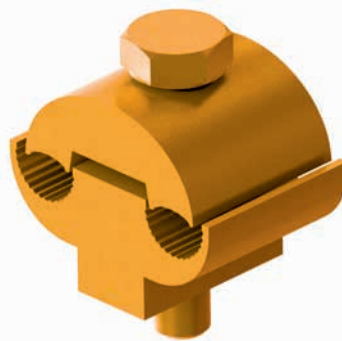

ORDER CODE	WEIGHT (K.G./PCS)
CKPE-1	0.050

CWB1



ORDER CODE	T (E.G.) (mm)	WEIGHT (E.G.) (K.G./PCS)	T (SS304) (mm)	WEIGHT (SS304) (K.G./PCS)
CWB1	3	0.040	3.0	0.045

CWB2



ORDER CODE	T (E.G.) (mm)	WEIGHT (E.G.) (K.G./PCS)	T (SS304) (mm)	WEIGHT (SS304) (K.G./PCS)
CWB2	3	0.040	3.0	0.045

Code : **CWB1051005**

CWB = Cable Tray Type
100 = Wiremesh Height
100 = Wiremesh Width
05 = Wiremesh Thickness

* e.g
 * h.d.g.
 * 304/316

* e.g+paint
 * h.d.g.+paint
 * 304 / 316+polished

CWB3



ORDER CODE	T (P.G.) (mm)	WEIGHT (P.G.) (K.G./PCS)	T (SS304) (mm)	WEIGHT (SS304) (K.G./PCS)
CWB3	2.0	0.040	3.0	0.044

CWB4



ORDER CODE	T (P.G.) (mm)	WEIGHT (P.G.) (K.G./PCS)	T (SS304) (mm)	WEIGHT (SS304) (K.G./PCS)
CWB4	2.0	0.040	3.0	0.044

CWB5

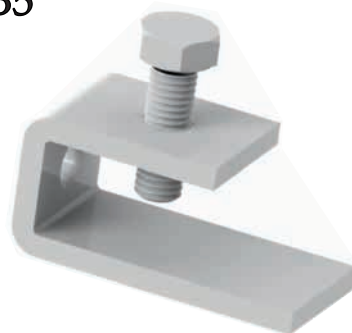

ORDER CODE	T (E.G.) (mm)	WEIGHT (E.G.) (K.G./PCS)
CWB5	4.0	0.090

CWB6



ORDER CODE	T (P.G.) (mm)	WEIGHT (P.G.) (K.G./PCS)	T (SS304) (mm)	WEIGHT (SS304) (K.G./PCS)
CWB6	2.0	0.210	2.0	0.230

CWB7

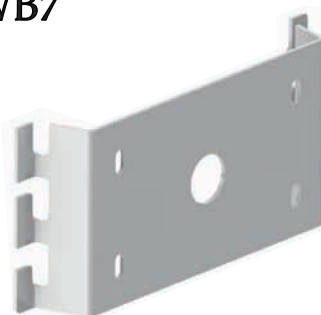

ORDER CODE	T (P.G.) (mm)	WEIGHT (P.G.) (K.G./PCS)	T (SS304) (mm)	WEIGHT (SS304) (K.G./PCS)
CWB7	2.0	0.290	2.0	0.320

CWB8



ORDER CODE	T (E.G.) (mm)	WEIGHT (E.G.) (K.G./PCS)	T (SS304) (mm)	WEIGHT (SS304) (K.G./PCS)
CWB8	3.0	0.030	3.0	0.040

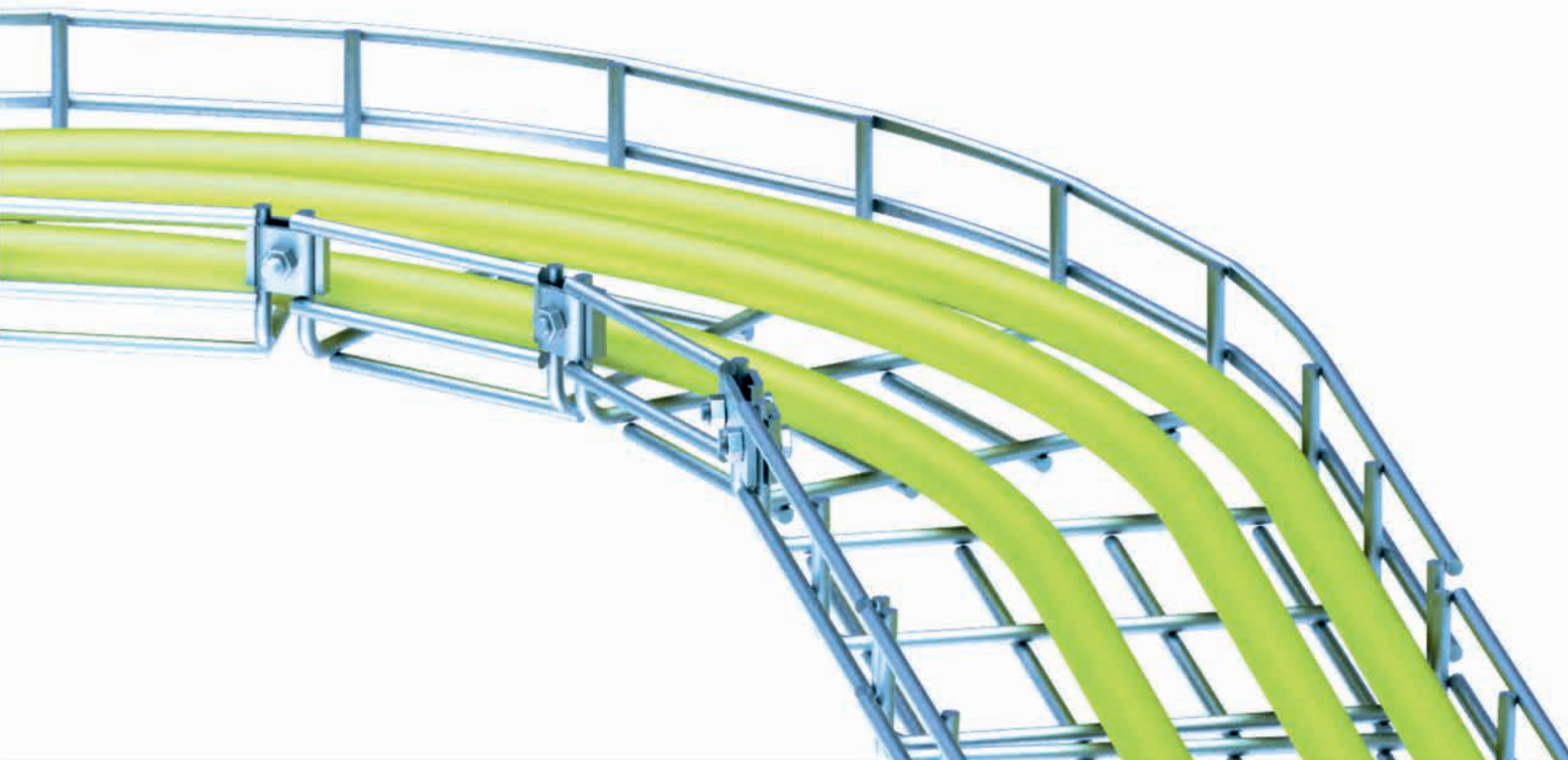





COMPASS TRADING

“Your COMPASS for quality”



Mehmet Akif Ersoy Mah.
2013. st. No. 39/9
Esenyurt /Istanbul / TURKEY



+9 0 212 852 90 52



+9 0 535 458 72 83



sales@compass-trading.net